

GE  
Lighting

# Evolve™ LED Flood Light

N Series (EFNA)



imagination at work

## Product Features

The next generation of the GE Evolve™ LED Flood Light is a bright solution to efficiently illuminate building façade, flag poles, billboard signage and many more traditional flood applications. The Evolve LED Flood Light has a diverse portfolio of optical patterns available to maximize efficiency, highlight effectively, and beautifully illuminate a range of diverse application spaces.

### Applications

- General flood applications, including, but not limited to; billboard/bulletin, spot and flag poles, building facade, and general parking.

### Housing

- Die-cast aluminum housing.
- Slim architectural design incorporates an integral heat sink and light engine, ensuring maximum heat transfer, long LED life, and a reduced Effective Projected Area (EPA).
- Meets 2G vibration level per ANSI C136.31-2010.



### LED & Optical Assembly

- Photometric system utilizes GE's advanced reflective LED optical system providing high uniformity, and excellent light distribution.
- Utilizes high brightness LEDs, 70CRI at 4000K and 5000K.

### Lumen Maintenance

- System rating is L85 @ 50,000 hours. Contact manufacturer for Lxx rating (Lumen Depreciation) beyond 50,000 hours..

### Ratings

-   listed, suitable for wet locations.
- IP66 rated optical enclosure per ANSI C136.25-2009.
- Temperature rated at -40° to 50°C.
- Compliant with the material restriction requirements of RoHS.

### Mounting

#### Option T

- Trunnion, pre-wired with 3ft #14/3 cable.

#### Option K

- Knuckle Slipfitter for 1.9" to 2.38" OD Tenon, pre-wired with 24-inch (610mm) leads.

#### Option S

- Knuckle Slipfitter mounting for 2.3-3" O.D. pipe, pre-wired with 24-inch (610mm) leads.

#### Option V

- Knuckle Wall Mount, pre-wired with 24-inch (610mm) leads.

### Finish

- Corrosion resistant polyester powder painted, minimum 2.0 mil. thickness.
- Standard colors: Black & Dark Bronze.
- RAL & custom colors available.

### Electrical

- 120-277 volt and 347-480 volt available.
- System power factor is >90% and THD <20%.
- Photo electric sensors (PE) available for all voltages.
- GE dimmable PE socket is available making the unit "adaptive controls ready." Contact manufacturer for details.
- Dimming:
  - Wired 0-10V continuous dimming with "D" option code
- Surge Protection Options:
  - For 120-277VAC and 347-480VAC per IEEE/ANSI C136.2-2014.
  - 6kV/3kA "Basic" surge protection, standard.
  - 10kV/5kA "Enhanced" surge protection available with "R" option code.

# Ordering Number Logic

## Evolve LED Flood Light N Series (EFNA)



E F N

A

5

PROD. ID	PHOTOMETRIC SERIES	VOLTAGE	OPTICAL CODE	DRIVE CURRENT	LED COLOR TEMP	PE FUNCTION	MOUNTING ARM	COLOR	OPTIONS
E = Evolve F = Flood Light N = Housing Series	A = Photometric Series "A"	0 = 120-277 1 = 120* 2 = 208* 3 = 240* 4 = 277* 5 = 480* H = 347-480V D = 347*  * Specify single voltage only if fuse option is selected.		5 = 525mA	40 = 4000K 50 = 5000K	1 = None 2 = PE Rec. 4 = PE Rec. with Shorting cap 5 = PE Rec. with Control** 7 = Dimming PE Receptacle †# 9 = Dimming PE Receptacle with Shorting Cap †# A = ANSI C136.41 7-pin PE Receptacle, contact manufacturer for availability †# D = ANSI C136.41 7-pin PE Receptacle with Shorting Cap, contact manufacturer for availability †#  ** PE control not available for 347-480V. Must be a discrete voltage (347V or 480V). † When ordering PE function socket 7, 9, or A-D, a dimming driver must also be ordered under the "OPTIONS" column. # Order Dimming/Control PE as a separate item.	T = Trunnion, pre-wired with 3ft #14/3 cable, standard* K = Knuckle Slipfitter for 1.9 in to 2.38 in OD Tenon S = Knuckle Slipfitter for 1.9 in to 3 in OD Tenon V = Knuckle Wall Mount  * When Dimming option is selected without Dimming PE, a #14-5 cable will be supplied at length above.	BLCK = Black DKBZ = Dark Bronze  Contact manufacturer for other colors	D = Dimming (0-10 Volt Input) † F = Fusing R = 10kV Enhanced Surge Protection P = Prewired with 6 FT #14/3 Cable* XXX = Special Options  † Dimming leads will be provided through the back of the arm, unless specified with 7 or 9 PE Function.  * When Dimming option is selected without Dimming PE, a #14-5 cable will be supplied at length above.

OPTICAL CODE	TYPE	TYPICAL INITIAL LUMENS		TYPICAL SYSTEM WATTAGE		IES FILE NUMBER	
		4000K	5000K	120-277V	347-480V	4000K	5000K
A4	Asymmetric Forward	3,730	3,750	46	N/A	EFNA_A4540_-120-277V.IES	EFNA_A4550_-120-277V.IES
B4	Asymmetric Forward	5,510	5,540	65	N/A	EFNA_B4540_-120-277V.IES	EFNA_B4550_-120-277V.IES
C4	Asymmetric Forward	7,180	7,210	85	85	EFNA_C4540_.IES	EFNA_C4550_.IES
D4	Asymmetric Forward	8,810	8,850	104	104	EFNA_D4540_.IES	EFNA_D4550_.IES
E4	Asymmetric Forward	10,370	10,410	123	123	EFNA_E4540_.IES	EFNA_E4550_.IES
F4	Asymmetric Forward	12,320	12,380	148	148	EFNA_F4540_.IES	EFNA_F4550_.IES
A3	Asymmetric Wide	4,070	4,090	46	N/A	EFNA_A3540_-120-277V.IES	EFNA_A3550_-120-277V.IES
B3	Asymmetric Wide	6,010	6,040	65	N/A	EFNA_B3540_-120-277V.IES	EFNA_B3550_-120-277V.IES
C3	Asymmetric Wide	7,830	7,860	85	85	EFNA_C3540_.IES	EFNA_C3550_.IES
D3	Asymmetric Wide	9,620	9,650	104	104	EFNA_D3540_.IES	EFNA_D3550_.IES
E3	Asymmetric Wide	11,320	11,360	123	123	EFNA_E3540_.IES	EFNA_E3550_.IES
F3	Asymmetric Wide	13,450	13,500	148	148	EFNA_F3540_.IES	EFNA_F3550_.IES
A2	Asymmetric Narrow	3,940	3,960	46	N/A	EFNA_A2540_-120-277V.IES	EFNA_A2550_-120-277V.IES
B2	Asymmetric Narrow	5,820	5,850	65	N/A	EFNA_B2540_-120-277V.IES	EFNA_B2550_-120-277V.IES
C2	Asymmetric Narrow	7,580	7,620	85	85	EFNA_C2540_.IES	EFNA_C2550_.IES
D2	Asymmetric Narrow	9,310	9,350	104	104	EFNA_D2540_.IES	EFNA_D2550_.IES
E2	Asymmetric Narrow	10,960	11,010	123	123	EFNA_E2540_.IES	EFNA_E2550_.IES
F2	Asymmetric Narrow	13,020	13,080	148	148	EFNA_F2540_.IES	EFNA_F2550_.IES
AS	20° Spot	4,340	4,360	46	N/A	EFNA_AS540_-120-277V.IES	EFNA_AS550_-120-277V.IES
BS	20° Spot	6,410	6,440	65	N/A	EFNA_BS540_-120-277V.IES	EFNA_BS550_-120-277V.IES
CS	20° Spot	8,350	8,380	85	85	EFNA_CS540_.IES	EFNA_CS550_.IES
DS	20° Spot	10,250	10,290	104	104	EFNA_DS540_.IES	EFNA_DS550_.IES
ES	20° Spot	12,060	12,100	123	123	EFNA_ES540_.IES	EFNA_ES550_.IES
FS	20° Spot	14,330	14,390	148	148	EFNA_FS540_.IES	EFNA_FS550_.IES
AW	80° Wide Flood	4,360	4,380	46	N/A	EFNA_AW540_-120-277V.IES	EFNA_AW550_-120-277V.IES
BW	80° Wide Flood	6,440	6,480	65	N/A	EFNA_BW540_-120-277V.IES	EFNA_BW550_-120-277V.IES
CW	80° Wide Flood	8,390	8,430	85	85	EFNA_CW540_.IES	EFNA_CW550_.IES
DW	80° Wide Flood	10,300	10,350	104	104	EFNA_DW540_.IES	EFNA_DW550_.IES
EW	80° Wide Flood	12,130	12,180	123	123	EFNA_EW540_.IES	EFNA_EW550_.IES
FW	80° Wide Flood	14,400	14,470	148	148	EFNA_FW540_.IES	EFNA_FW550_.IES
AE	100° Extra Wide Flood	4,260	4,290	46	N/A	EFNA_AE540_-120-277V.IES	EFNA_AE550_-120-277V.IES
BE	100° Extra Wide Flood	6,300	6,330	65	N/A	EFNA_BE540_-120-277V.IES	EFNA_BE550_-120-277V.IES
CE	100° Extra Wide Flood	8,200	8,240	85	85	EFNA_CE540_.IES	EFNA_CE550_.IES
DE	100° Extra Wide Flood	10,070	10,120	104	104	EFNA_DE540_.IES	EFNA_DE550_.IES
EE	100° Extra Wide Flood	11,860	11,910	123	123	EFNA_EE540_.IES	EFNA_EE550_.IES
FE	100° Extra Wide Flood	14,090	14,150	148	148	EFNA_FE540_.IES	EFNA_FE550_.IES

# Photometrics

**EFNA Type IV - Asymmetric Forward (F4)**  
 12,380 Lumens, 5000K (EFNA\_F4550\_\_.IES)  
 Fixture mounted at 0° Horizontal

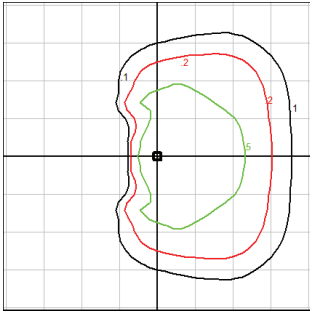

Grid Distance in Units of Mounting Height at 30' Initial Footcandle Values at Grade

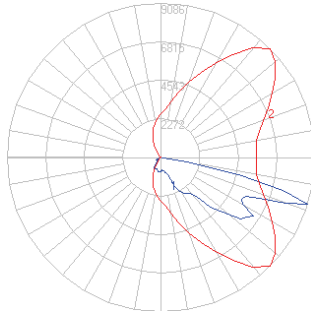

— Vertical plane through horizontal angle of maximum candlepower at 45°  
 — Vertical plane through horizontal angle of 72.5°

**EFNA Type IV - Asymmetric Forward (A4)**  
 3,750 Lumens, 5000K (EFNA\_A4550\_\_-120-277V.IES)  
 Fixture mounted at 0° Horizontal

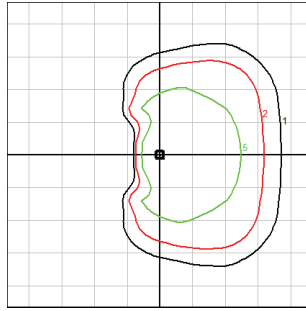

Grid Distance in Units of Mounting Height at 15' Initial Footcandle Values at Grade

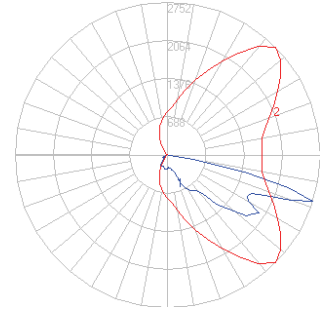

— Vertical plane through horizontal angle of maximum candlepower at 45°  
 — Vertical plane through horizontal angle of 72.5°

**EFNA Type III - Asymmetric Wide (F3)**  
 13,500 Lumens, 5000K (EFNA\_F3550\_\_.IES)  
 Fixture mounted at 0° Horizontal

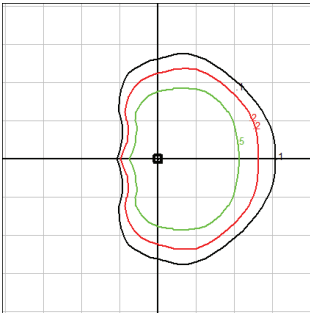

Grid Distance in Units of Mounting Height at 30' Initial Footcandle Values at Grade

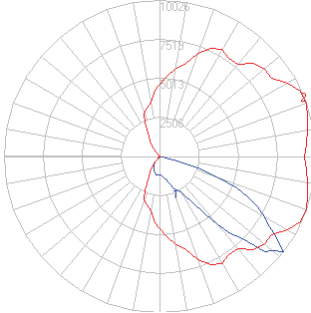

— Vertical plane through horizontal angle of maximum candlepower at 20°  
 — Vertical plane through horizontal angle of 52.5°

**EFNA Type III - Asymmetric Wide (A3)**  
 4,090 Lumens, 5000K (EFNA\_A3550\_\_-120-277V.IES)  
 Fixture mounted at 0° Horizontal

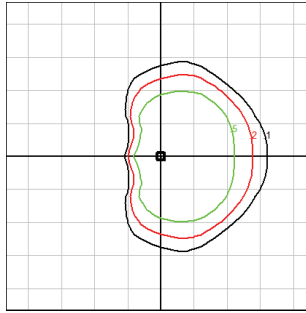

Grid Distance in Units of Mounting Height at 15' Initial Footcandle Values at Grade

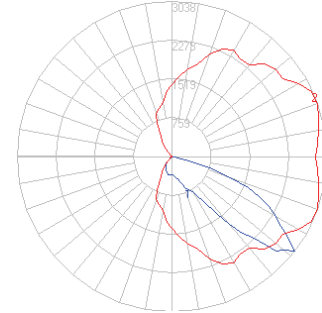

— Vertical plane through horizontal angle of maximum candlepower at 20°  
 — Vertical plane through horizontal angle of 52.5°

**EFNA Type II - Asymmetric Narrow (F2)**  
 13,080 Lumens, 5000K (EFNA\_F2550\_\_.IES)  
 Fixture mounted at 0° Horizontal

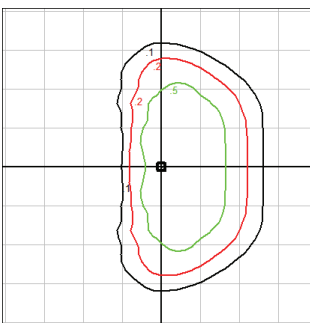

Distance in Units of Mounting Height at 30' Initial Footcandle Values at Grade

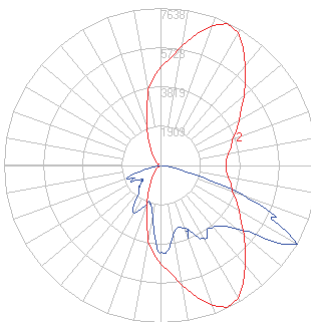

— Vertical plane through horizontal angle of maximum candlepower at 65°  
 — Vertical plane through horizontal angle of 60°

**EFNA Type II - Asymmetric Narrow (A2)**  
 3,960 Lumens, 5000K (EFNA\_A2550\_\_-120-277V.IES)  
 Fixture mounted at 0° Horizontal

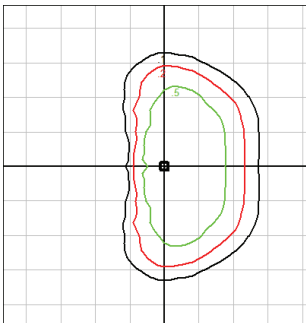

Grid Distance in Units of Mounting Height at 15' Initial Footcandle Values at Grade

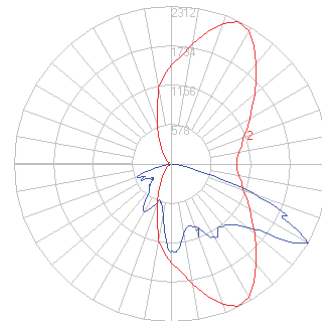

— Vertical plane through horizontal angle of maximum candlepower at 65°  
 — Vertical plane through horizontal angle of 60°

# Photometrics

**EFNA – 20° Spot (FS)**  
14,390 Lumens, 5000K (EFNA\_FS550\_\_IES)

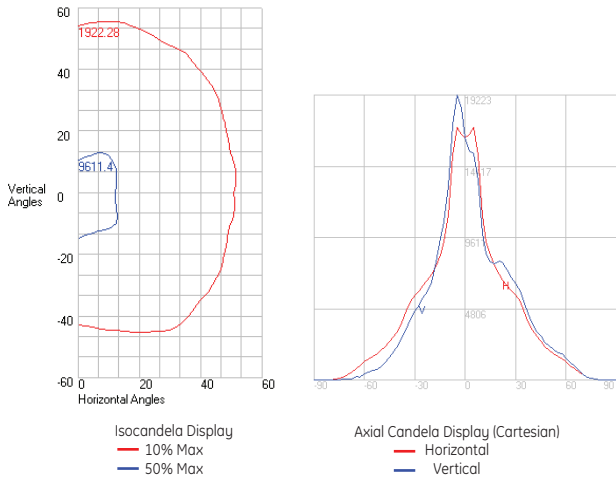

**EFNA – 20° Spot (AS)**  
4,360 Lumens, 5000K (EFNA\_AS550\_\_-120-277V.IES)

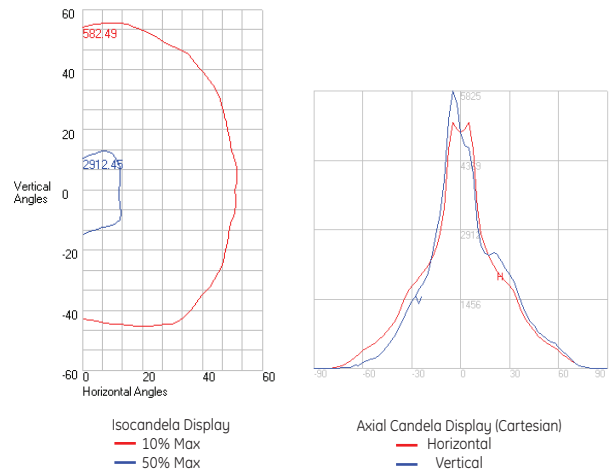

**EFNA – 80° Wide Flood (FW)**  
14,470 Lumens, 5000K (EFNA\_FW550\_\_IES)

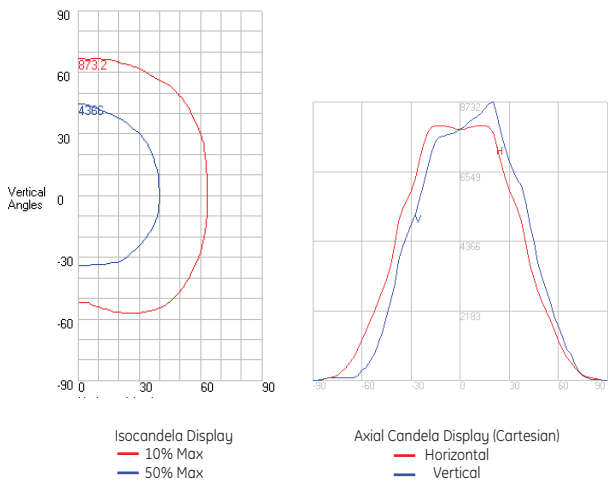

**EFNA – 80° Wide Flood (AW)**  
4,380 Lumens, 5000K (EFNA\_AW550\_\_-120-277V.IES)

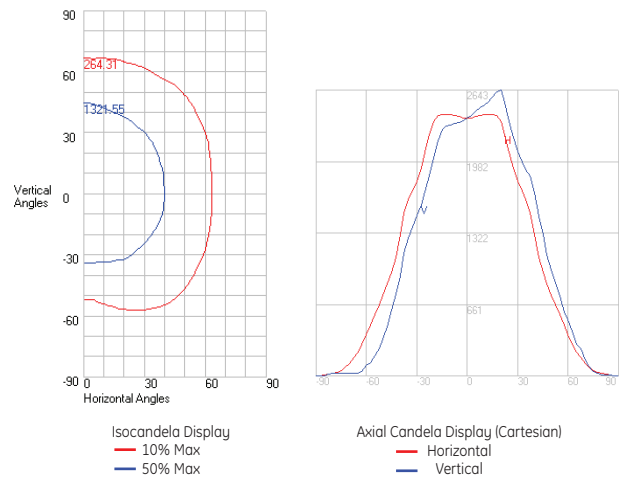

**EFNA – 100° Extra Wide Flood (FE)**  
14,150 Lumens, 5000K (EFNA\_FE550\_\_IES)

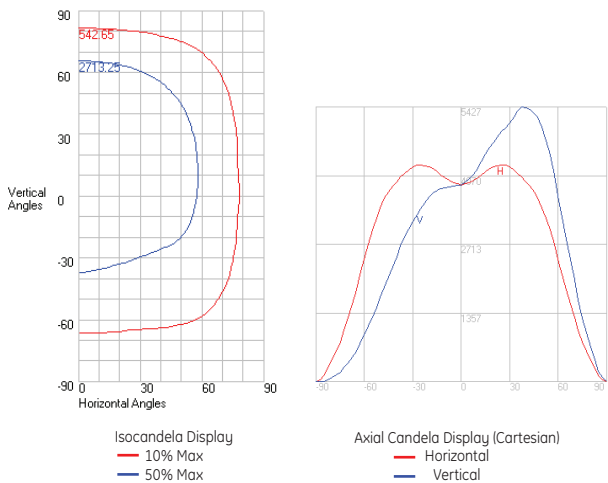

**Extra Wide Flood (AE)**  
4,290 Lumens, 5000K (EFNA\_AE550\_\_-120-277V.IES)

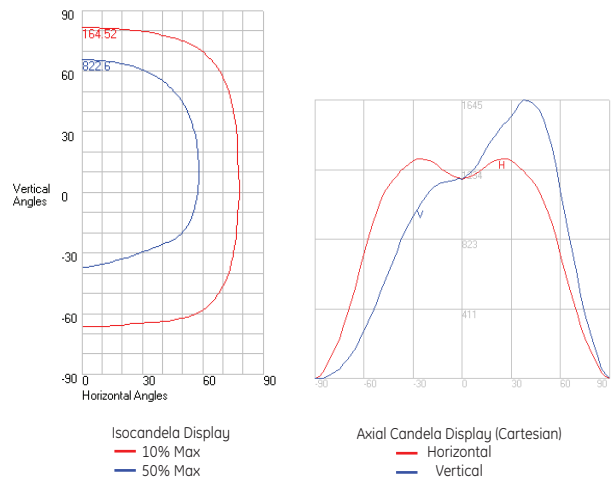

# Product Dimensions

## Flood Light Slipfitter Mount

ISOMETRIC VIEW

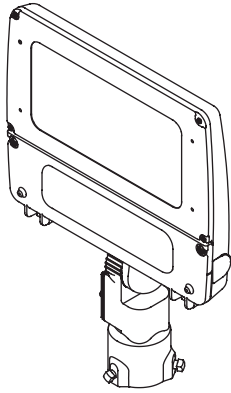

FRONT VIEW

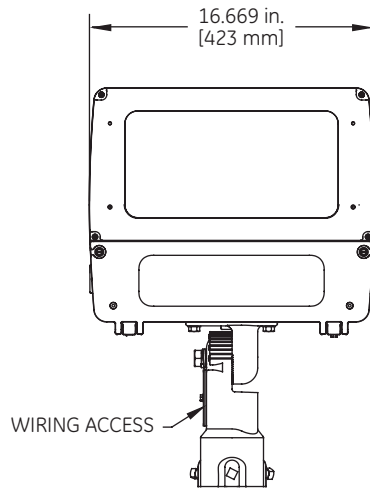

SIDE VIEW

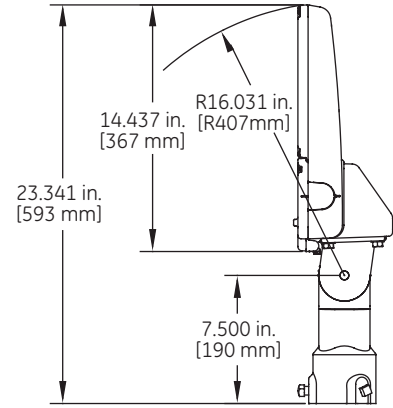

**DATA**

- Approximate Net Weight: 21 lbs (9.52 kgs)
- Effective Projected Area (EPA) with Knuckle Mount: 0.56 sq ft max (0.05 sq. m)

## Flood Light Wall Mount

ISOMETRIC VIEW

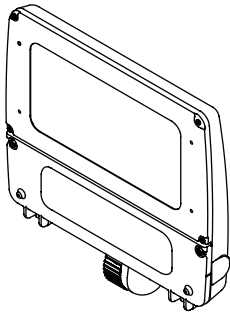

FRONT VIEW

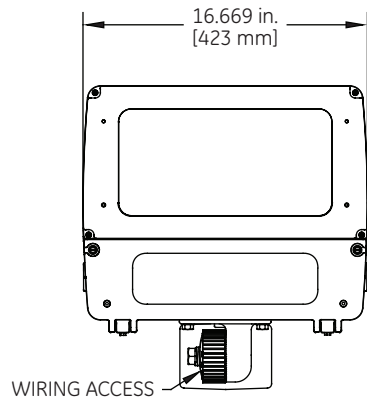

SIDE VIEW

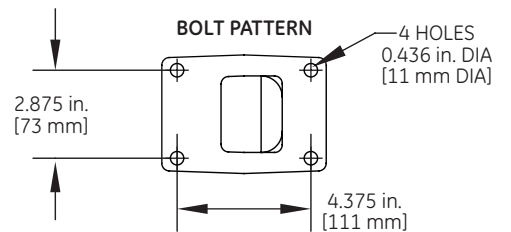
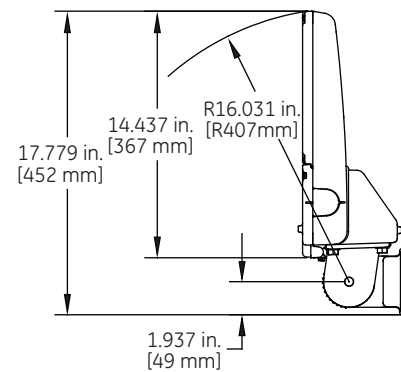

**DATA**

- Approximate Net Weight: 21 lbs (9.52 kgs)
- Effective Projected Area (EPA) with Knuckle Mount: 0.43 sq ft max (0.04 sq. m)

# Product Dimensions

## Flood Light Trunnion

ISOMETRIC VIEW

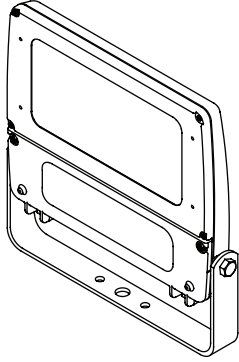

FRONT VIEW

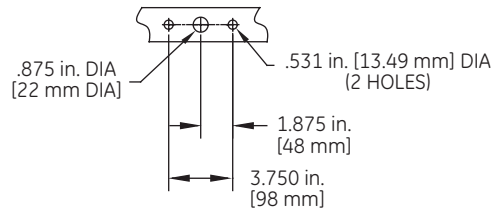
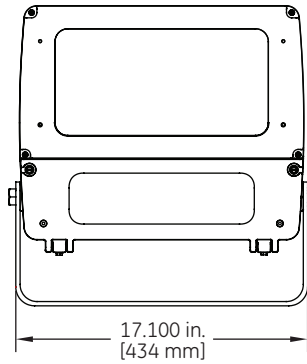

SIDE VIEW

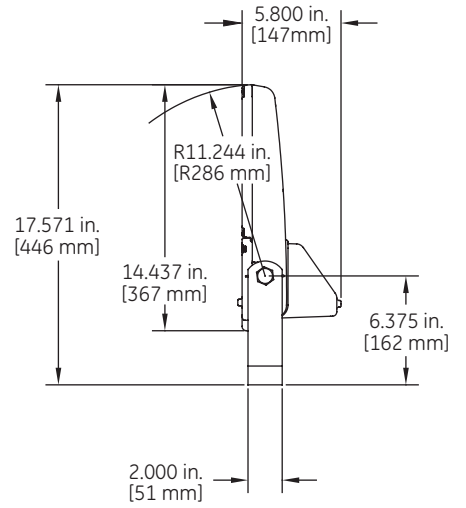

DATA

- Approximate Net Weight: 22 lbs (9.97 kgs)
- Effective Projected Area (EPA) with Trunnion Mount: 0.39 sq ft max (0.03 sq. m)



[www.gelighting.com](http://www.gelighting.com)

GE and the GE Monogram are trademarks of the General Electric Company. All other trademarks are the property of their respective owners. Information provided is subject to change without notice. All values are design or typical values when measured under laboratory conditions. GE Lighting and GE Lighting Solutions, LLC are businesses of the General Electric Company. © 2014 GE.

OLP3081 (Rev 11/25/14)